

# NOTIFICATION OF ELECTRICAL POWER ISOLATION



To ensure a safe and reliable electricity supply system, Facilities Management Division (FMD) is executing a programme to repair and replace electrical switchboards at the Wollongong Campus.

To carry out these works, isolation of electrical power will be required within your building as follows:

<b>BUILDING:</b>	36
<b>SWITCHBOARD/S:</b>	DB-5                      DB-7                      DB-COMP1
<b>AREAS EFFECTED:</b>	Refer to attached switchboard circuit schedules and layout drawing.
<b>DATES &amp; TIMES:</b>	Refer to attached programme

Prior to the above stated date and time, FMD recommends the following:

- To minimise risk of damage, disconnect and unplug any sensitive electronic equipment
- Shut down your computer to prevent loss of any unsaved data
- Avoid opening fridges and freezers during the interruption to keep items cool



Unforeseen circumstances may cause the date and/or time of this isolation to change. FMD will issue an updated notice should this occur.

We apologise for any inconvenience. Please be aware that FMD will not be liable to pay compensation for damage, loss, or inconvenience incurred due to this essential maintenance being performed.

#### To Contact us:

If you have any questions regarding the proposed works, or if you have critical equipment that cannot be isolated in your building please contact the FMD Service Centre (4221 3217 or [fm-service-centre@uow.edu.au](mailto:fm-service-centre@uow.edu.au)).



UNIVERSITY  
OF WOLLONGONG  
AUSTRALIA



# PROGRAMME

SWITCHBOARD	DATE	TIME
DB5 & DB 7	Thursday, 17 December 2020	6pm-2am
DB COMP 1	Friday, 18 December 2020	6pm-2am

# SWITCHBOARD CIRCUIT SCHEDULES

DB-5:

SMITHBILT ELECTRICAL INDUSTRIES PTY. LTD.  
 25 HARLEY CRESCENT, CONDELL PARK 2200

N 2388 59  
27/6/80

No.	DESCRIPTION
1	9 x 2 x 40W Fluoros. 20A
	Plant Room <sup>250W Fluorescent</sup> <sup>lights Fed on 200A</sup>
2	A/C 1 Finance Area 32A
3	A/C 2 Finance Area 32A
4	A/C 3 Finance Area 20A
5	A/C 4 Finance Area 20A
6	A/C 5 Finance Area 20A
7	A/C 6 Finance Area 20A
8	A/C 7 Finance Area 20A
9	A/C 8 Finance Area 20A
14	Emergency Lighting
15	3GPOS. 20A Plant Room

**DB-7:**

CIRCUIT NO.	NEUTRAL NO.	CURRENT RATING	DESCRIPTION	CIRCUIT NO.	NEUTRAL NO.	CURRENT RATING	DESCRIPTION
1	1	20	L1-24 (4x24W) fluorescent lights offices	2	2	20	4 Double GPO Hallway and 3 double GPO PTZ Cameras
3	3	20	L2-18 (4x24W) Fluorescent office	4	4	20	Double GPO Skirting Duct-Office Area
5	5	20	L3-12 (2 x 28W) fluorescent lights-hallway	6	6	20	Double GPO Skirting Duct-Office Area
7	7	20	L4-6(2x28W) Fluorescent and 6 x 200 downlights-toyer	8	8	20	10 Double GPO-Office Area
9	9	20	L5-4(2x36W) Fluorescent & 9 x 100 downlights-Dispiay Boxes	10	10	20	8 Double GPO-Office Area
11				12	12	20	Etsafe Power Outlet-floor Box
13				14	14	20	Etsafe Power Outlet-floor Box
15				16	16	20	BBQ Supply
17				18	18	20	Stage GPO 20A
19				20	20	20	Stage GPO 20A
21				22	22	20	Stage GPO 20A
23				24	24	20	Stage GPO 20A
25				26	26	20	BBQ Supply
27				28	28	20	Water Pump
29				30	30	20	4 GPO'S Deck
31				32	32	20	4 GPO'S Deck
33				34	34	20	GPO'S DECKS M/ROOM
35				36	36	20	15A GPO CS RM 102
37				38			

# DB-COMP1:

DB - ITS.	
1	} MAIN SWITCH 3 PHASE
2	
3	
4	15 AMP GPO
5	15 AMP GPO WEST WALL
6	15 AMP GPO " "
7	15 AMP GPO " "
8	20 AMP GPO WEST WALL
9	20 AMP " " "
10	20 AMP " " "
11	20 AMP " " "
15	AC Unit - SPARE
17	LIGHTS COMMS ROOM
[REDACTED]	
20	
21	
22	
23	15 AMP GPO WEST WALL
24	
25	15 AMP GPO WEST WALL

# SWITCHBOARD LOCATIONS

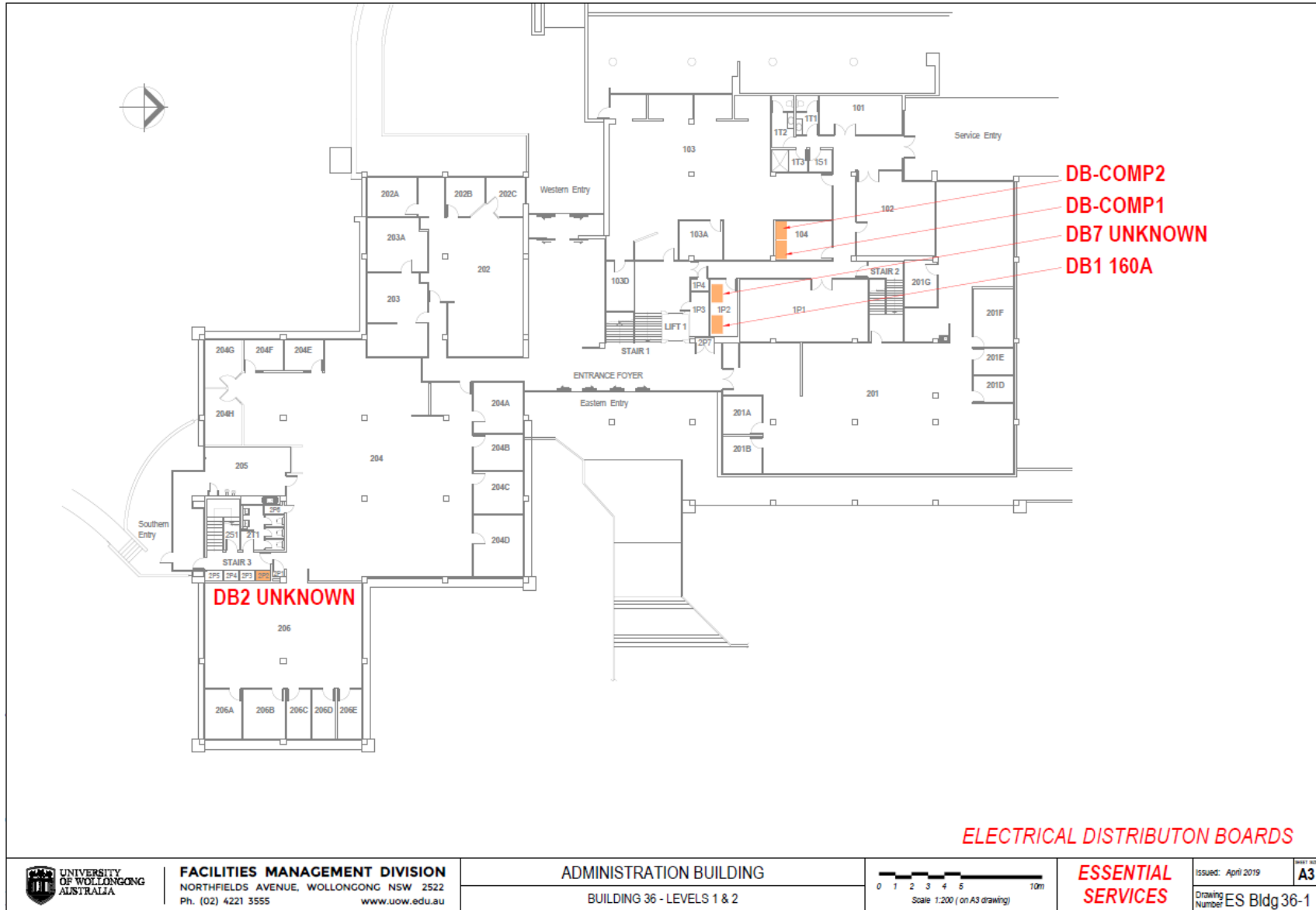

**ELECTRICAL DISTRIBUTION BOARDS**



**FACILITIES MANAGEMENT DIVISION**  
 NORTHFIELDS AVENUE, WOLLONGONG NSW 2522  
 Ph. (02) 4221 3555 www.uow.edu.au

**ADMINISTRATION BUILDING**  
 BUILDING 36 - LEVELS 1 & 2

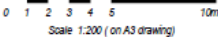

**ESSENTIAL SERVICES**

Issued: April 2019  
 Drawing Number: ES Bldg 36-1

**A3**



**ELECTRICAL DISTRIBUTION BOARDS**



**FACILITIES MANAGEMENT DIVISION**  
 NORTHFIELDS AVENUE, WOLLONGONG NSW 2522  
 Ph. (02) 4221 3555 www.uow.edu.au

**ADMINISTRATION BUILDING**  
 BUILDING 36 - LEVELS 3 & 4

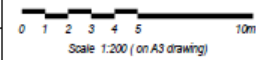

**ESSENTIAL SERVICES**

Issued: April 2019  
 Drawing Number: ES Bldg 36-2  
**A3**